

## RANGER+ KITCHEN

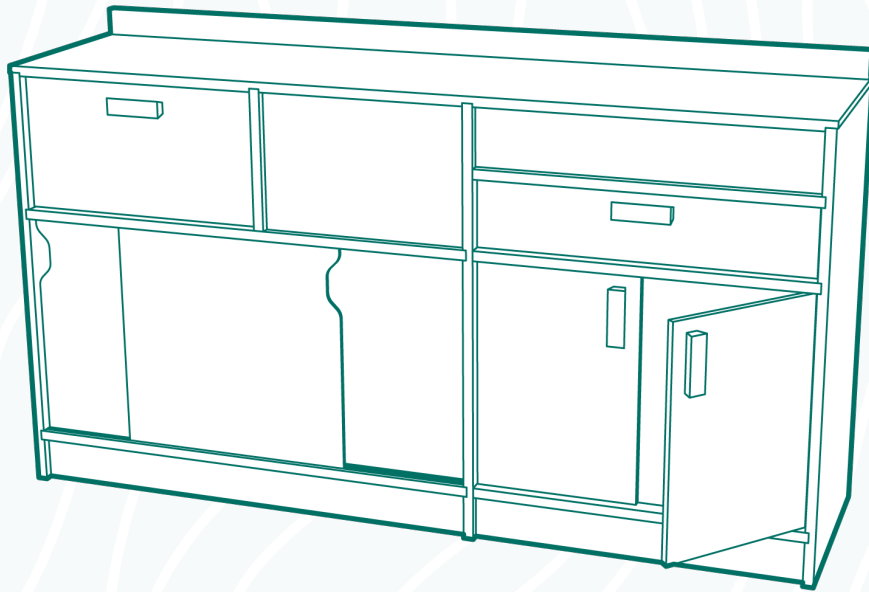

### STANDARD UNIT

| Feature    | Details                                                                                           | Size (WxDxH)   |
|------------|---------------------------------------------------------------------------------------------------|----------------|
| Frame      | 18mm Birch plywood, weight reducing cut-outs, high-strength joinery. Hob/sink cutouts on request. | 1486x380x785mm |
| Drawer LHS | 12mm Birch plywood with oak dowels & push to open runners                                         | 405x304x225mm  |
| Drawer RHS | 12mm Birch plywood with push to open runners                                                      | 536x304x97mm   |
| Cupboard 1 | 6mm MDF sliding doors                                                                             | 846x360x515mm  |
| Cupboard 2 | Birch plywood twin doors with soft close hinges & magnetic catches.                               | 586x360x515mm  |
|            | <b>Cost</b>                                                                                       | See Price List |

## OPTIONAL EXTRAS

| Feature     | Details                                                                                                 |
|-------------|---------------------------------------------------------------------------------------------------------|
| Oak Plywood | Oak plywood worktop & frame                                                                             |
| Assembly    | Fully assembled for collection.                                                                         |
| Finishing   | All parts sanded, Frame oiled with Osmo Polyx-Oil, doors painted with choice of eggshell kitchen paint. |

## KEY DIMENSIONS

