

## SQUALL KITCHEN SWB

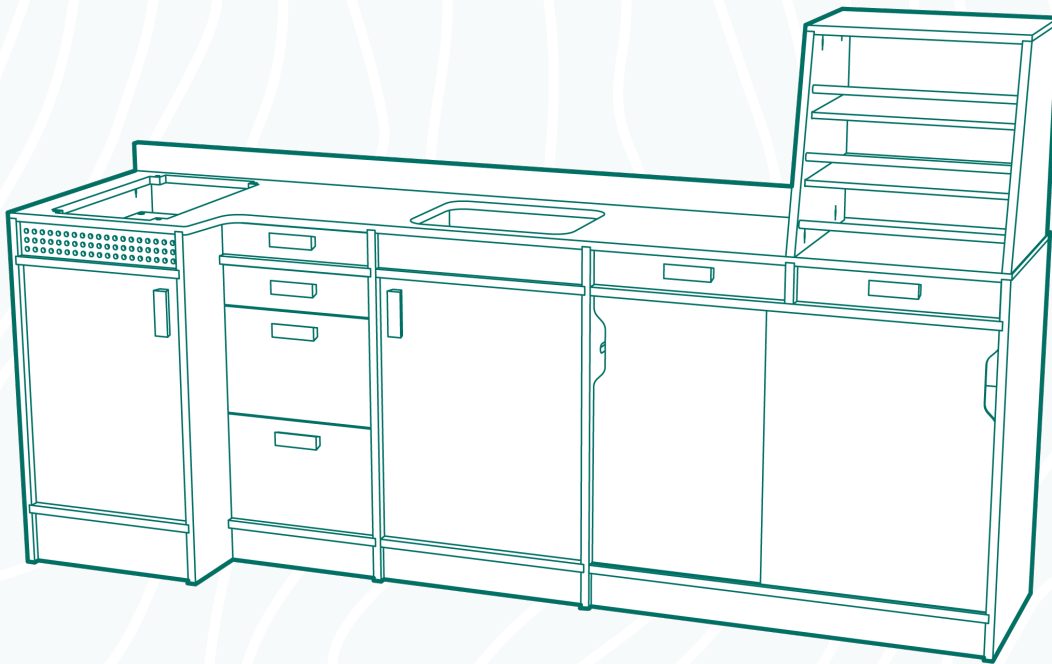

### STANDARD UNIT

Feature	Details	Size (WxDxH)
Frame	18mm Birch plywood, weight reducing cut-outs, high-strength joinery. Hob/sink cutouts on request.	2154x589x1250mm
LHS Cupboard	Choose to use as a cupboard or fit a Dometic CRX50 fridge.	390x556x551mm
Centre Drawers	Four drawers of various sizes, can be converted into gas cupboard if necessary.	
Centre Cupboard	Houses two 16L water containers.	468x396x686mm
Right Hand Cupboard	6mm sliding doors, houses leisure battery and additional shelf.	847x396x585mm
		<b>Cost</b> See Price List

## OPTIONAL EXTRAS

Feature	Details
Oak Plywood	Oak plywood worktop & frame
Assembly	Fully assembled for collection.
Finishing	All parts sanded, Frame oiled with Osmo Polyx-Oil, doors painted with choice of eggshell kitchen paint.
Water, Gas, Appliances	Systems can be designed and installed on request.

## KEY DIMENSIONS

Designed for: VW Transporter, Ford Transit Custom, Vauxhall Vivaro, Renault Traffic and other similar sized SWB vans.

